



Learjet 55C

The Learjet 55 was Lear's entry into the medium sized business jet field. In designing the 55, Learjet utilizes the earlier Longhorn 28/29 wing with winglets and marries it to a larger fuselage. The step-down aisle in the cabin has 5 ft 9 inches of headroom. Power is supplied by two Honeywell TFE 731 engines that produce 3,700 pounds of thrust each.

The Learjet 55B introduced a digital flight deck, modified wings, and an improved interior.

The 55C comes equipped with Delta Fins that improve performance and handling.

The first production aircraft flew on August 11, 1980.



ESTIMATED VARIABLE COSTS - Per Hour

	Learjet 55/55B	Learjet 55C	
Fuel (1)	\$1,638.00	\$1,638.00	\$-
Fuel Additives	12.60	12.60	-
Lubricants	-	-	-
Maintenance Labor (2)	372.02	324.85	-
Parts Airframe/Eng/Avion (3)	294.21	257.34	-
Engine Restoration (4)	433.08	433.08	-
Thrust Reverser Overhaul	12.85	12.85	-
Propeller Overhaul	-	-	-
APU Overhaul	-	-	-
Major Periodic Maintenance	-	-	-
Misc Exp. - Landing/Parking	17.74	17.33	-
- Crew Expenses	70.00	70.00	-
- Supplies/Catering	36.00	36.00	-
- Other	-	-	-
Fractional Cost/Hour + Tax	-	-	-
Total Variable Cost/Hour	\$2,886.50	\$2,802.05	\$-
Average Speed-Kts. (5) 600-nm trip	426.00	426.00	-
Cost per Nautical Mile	\$6.78	\$6.58	\$-

FOOTNOTES - Size of Operation: 1 - 2 Aircraft

Date: 12/12/2008

Currency: \$

Type of Operation:

	Corporate	Corporate	
1. Fuel Cost	6.50	6.50	-
Gallons/Hour	252	252	-
2. Maint. Labor Cost per Hour	89	89	-
Maint. Hours/Flight Hours	4.18	3.65	-
3. Incl. Engine Parts Cost	No	No	
Model	TFE 731-3AR	TFE 731-3AR	
4. Overhaul Cost Source	JSSI Comp08	JSSI Comp08	
5. Block Speed Source	Mftr Data	Mftr Data	



ANNUAL FIXED COSTS

	Learjet 55/55B	Learjet 55C	
Crew salaries - Captain (6)	\$100,100	\$100,100	\$-
- Co Pilot	72,000	72,000	-
- Flt Eng/Other	-	-	-
- Benefits	51,630	51,630	-
Hangar - Typical	31,800	31,800	-
Insurance - Hull (7)	32,560	35,200	-
Admitted Liability	1,575	1,575	-
Legal Liability	13,750	13,750	-
Recurrent Training	29,400	29,400	-
Aircraft Modernization (8)	52,500	52,500	-
Navigation Chart Service	4,166	4,166	-
Refurbishing (9)	24,920	24,920	-
Computer Mx. Program (10)	4,500	4,500	-
Weather Service (11)	700	700	-
Other Fixed Costs	-	-	-
Mgmt Fee/Yr + Tax	-	-	-
Total Fixed Cost/Year	\$419,601	\$422,241	\$-

FOOTNOTES -

Size of Operation: 1 - 2 Aircraft

Date: 12/12/2008

Currency: \$

6. Crew Salary Source	07 NBAA	07 NBAA	
Number of Crew	2	2	-
7. Ins Hull Value/Frac Share Cost	3,700,000	4,000,000	-
Hull Insurance Rate (%)	0.88	0.88	-
8. Modernization	10 Yr Avg	10 Yr Avg	
9. Refurbish Labor Hrs/Seat	40	40	-
10. Comp. Mx Program Source	Typical	Typical	
11. Weather Service Source	Typical	Typical	



ANNUAL BUDGET

	Learjet 55/55B	Learjet 55C	
Utilization - Nt. Miles	175,000	175,000	-
- Hours	411	411	-
Variable Cost	1,186,352	1,151,643	-
Fixed Cost	419,601	422,241	-
Total Cost (No Depreciation)	\$1,605,953	\$1,573,884	\$-
- Per Hour	3,907.00	3,829.00	-
- Per Nt. Mile	9.18	8.99	-
- Per Seat Nt. Mile	1.31	1.28	-
Total Cost (No Depreciation)	1,605,953	1,573,884	-
Book Depreciation (12)	370,000	400,000	-
Total Cost (Book Dep)	\$1,975,953	\$1,973,884	\$-
- Per Hour	4,808.00	4,803.00	-
- Per Nt. Mile	11.29	11.28	-
- Per Seat Nt. Mile	1.61	1.61	-
Total Cost (No Depreciation)	1,605,953	1,573,884	-
Market Depreciation (13)	148,000	160,000	-
Total Cost (Market Dep.)	\$1,753,953	\$1,733,884	\$-
- Per Hour	4,268.00	4,219.00	-
- Per Nt. Mile	10.02	9.91	-
- Per Seat Nt. Mile	1.43	1.42	-

Footnotes - Size of Operation: 1 - 2 Aircraft

Date: 12/12/2008

Currency: \$

12. Book Depreciation Rate	10% per yr	10% per yr	
13. Market Depreciation Rate	4.00	4.00	-



GENERAL COMPARISON

	Learjet 55/55B	Learjet 55C	
Cabin-Height (Ft.)	5.75	5.75	-
- Width	5.90	5.90	-
- Length	16.70	16.70	-
Cabin volume (Cu. Ft.)	407.00	407.00	-
Cabin Door Height (Ft.)	5.30	5.30	-
- Width	2.00	2.00	-
Baggage -Int. (Cu.Ft.)	40.00	40.00	-
- External	20.00	20.00	-
Typical Crew/Pass Seating	2/7	2/7	
Weight-Max Take-off (Lbs.)	21,500	21,000	-
- Maximum Landing	18,000	18,000	-
- Basic Operating	12,550	13,022	-
- Usable Fuel	6,705	6,690	-
Payload-Full Fuel (Lbs.)	2,495	1,788	-
- Maximum	2,450	1,978	-
Certified/IFR Certified	Yes/Yes	Yes/Yes	
Price - New (Corporate)/1000	4,720.00	6,900.00	-
- Pre Owned Rng/1000	3,000/3,700	3,800/4,000	
- Years Produced	1981 - 1987	1988 - 1992	

PERFORMANCE COMPARISON

	Learjet 55/55B	Learjet 55C	
Range-NBAA IFR Res (N.Mi.)			
Seats Full	1,870	1,870	-
Ferry Range	2,040	2,040	-
Range-30 Min. Res (N.Mi.)			
Seats Full	-	-	-
Ferry Range	-	-	-
Balanced Field Length (Ft.)	5,000	5,800	-
Landing Distance - FAR 121	4,565	4,800	-
Rate Of Climb (Ft/Min)	4,059	4,176	-
- One Engine Out	1,200	1,240	-
Cruise Speed-Max (KTAS)	490	490	-
- Normal	447	447	-
- Long Range	420	420	-
Stall Speed (IAS)	96	95	-
Ceiling-Service MTOW (Ft.)	41,000	41,000	-
- Service OEI	25,400	25,400	-
- Hover IGE (Helicopter Only)	-	-	-
- Hover OGE (Helicopter Only)	-	-	-

INTERIOR

Scale = 1:30

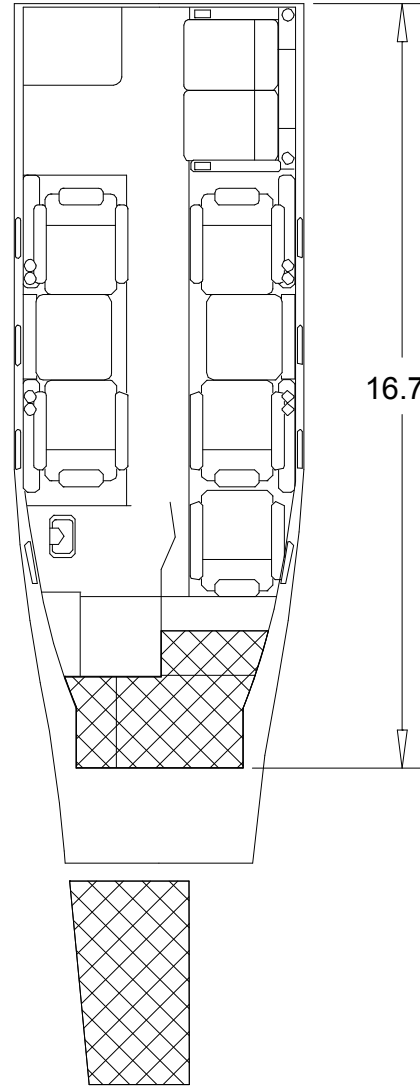
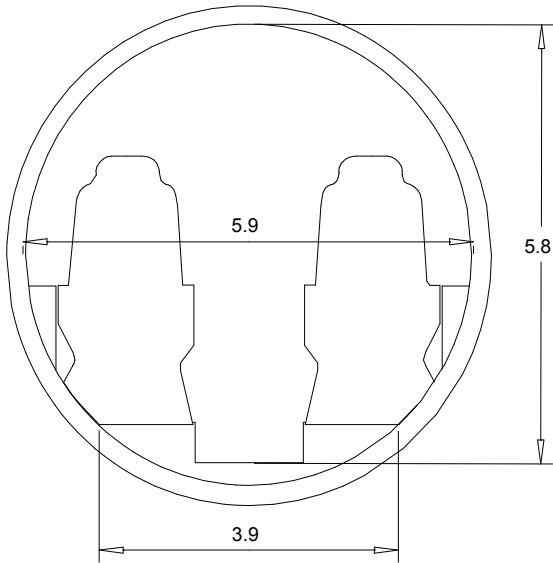

Learjet 55/55B

Scale = 1:50

 - Baggage

All dimensions are measured in Feet unless otherwise specified.

EXTERIOR

Scale = 1:150

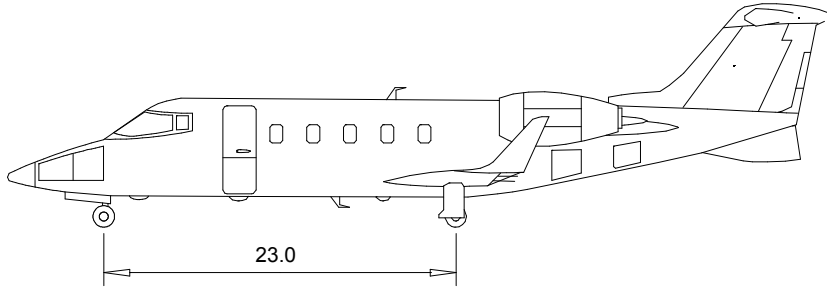

Learjet 55/55B

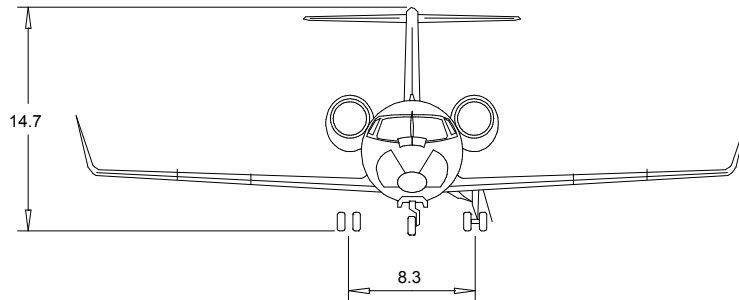
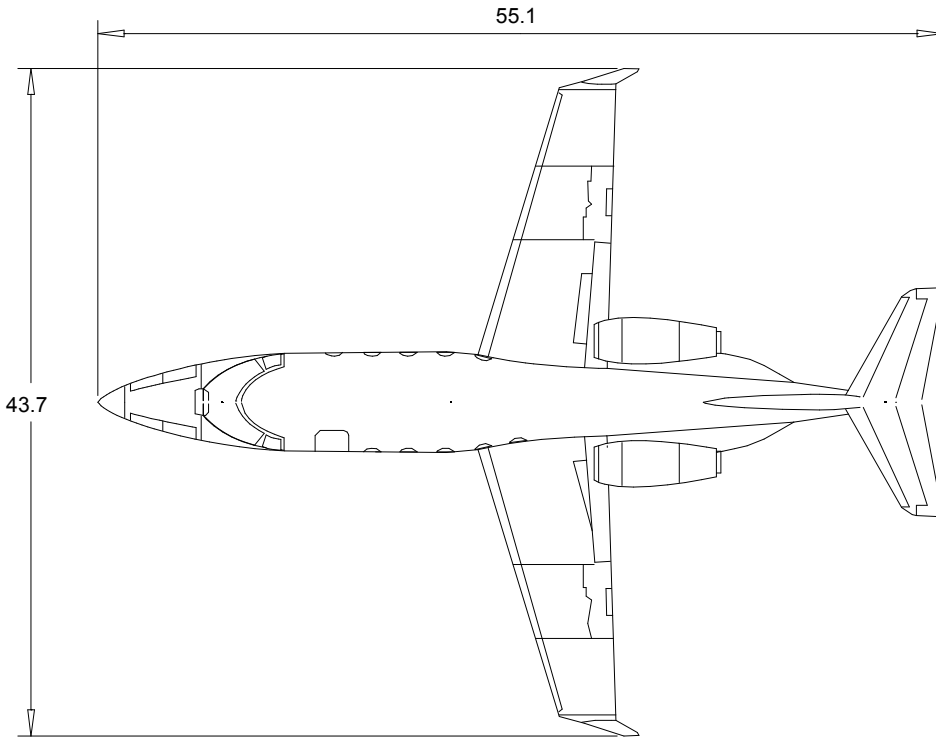

All dimensions are measured in Feet unless otherwise specified.